

# 14225 Foam Wheeled It 25 Stainless steel

Approved EN 1866-1:2008, Marina MED, highest rate achieved - A IVB



CSI Certificate  
MED/0497/136/09



Organic solid materials,  
wood rubber, textiles etc.



Flammable liquids,  
gasoline, oil etc.

### According directive 96/98/EC, EN 1866 and with CE-mark

The wheeled fire extinguisher is manufactured according to Directive 96/98/EC (MED) with modules B and D.  
As with portable extinguishers, wheeled units also have to comply with high standards to ensure their extinguishing capability (fire rating), quality and reliability.  
We at a.b.s. know how important it is to make the right choice in fire fighting.  
Recently, a new European standard for wheeled extinguishers, EN 1866, was introduced.  
The a.b.s. wheeled extinguisher range, has been the first in Europe to comply with this standard.  
The wheeled units also carry the CE mark so the range can boast three quality guarantees :a.b.s. (ISO 9001), compliance with EN 1866 and the CE mark.  
The standard EN1866 defines important minimum levels of pressure retention, corrosion protection, operating temperatures and fire rating.

### Technical Characteristics

Wheeled extinguisher is designed for professional use under severe circumstances, resulting in a high level of quality and ease of use.  
The cylinder, CE marked, it has the welded frame or detachable frame.  
Ease of mobility is achieved as a result of the large wheels with solid rubber tyres and push bar also ensuring good stability during operation.

### 2" Lever valve

The valve is made in brass (STCW617N) and it passed all the requirements of the directive 97/23/EC.  
There is a safety device at 22 bar. There is a green safety seal to improve the optical check from far.  
Only a simple glance is enough to check if the extinguisher has been tampered.

### Pressure gauge

Pressure gauge is brass galvanized the thread is M10x1 with o-ring for easy unscrew to check the real internal pressure any time without need of tools.  
If the indicator is in the green field, the extinguisher is ready to be used. If the indicator is in the red field, call immediately the authorized service staff.

### Discharge device

Equipped with a highly flexible hose made in EPDM rubber with an excellent resistance manufactured from selected synthetic materials complete with a pistol.  
The specially designed ergonomic patented foam nozzle ensures a steady flow of foam with a very low drop in pressure.

### Extinguishing agent

Sealfire® Super concentrate is the most powerful product registered by a.b.s. s.r.l. formulated for fire extinguisher.  
It is an additive AFFF based, specially formulated for best sealing effects.

Permanent stored pressure



Stainless Steel Cylinder

Swivel coupling  
It allows easy unrolling of the hose avoiding twisting

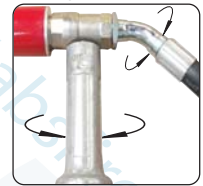

### Advantages

- Very mobile and easy to operate
- Excellent quality, therefore a long operational lifetime
- Good ergonomics, easy to drive
- Extremely high ratings on A, B fires (solid combustibles, liquid fuels)
- Can be used at low temperatures (+0°C). On request -30°C or -20°C.
- Easy to service
- First in Europe in accordance with the new EN 1866 standards
- With CE approval
- Other Foam types available.

### - Test method and result -

The 233B tray has been used and four 21B trays have been installed alongside, as from the following design.

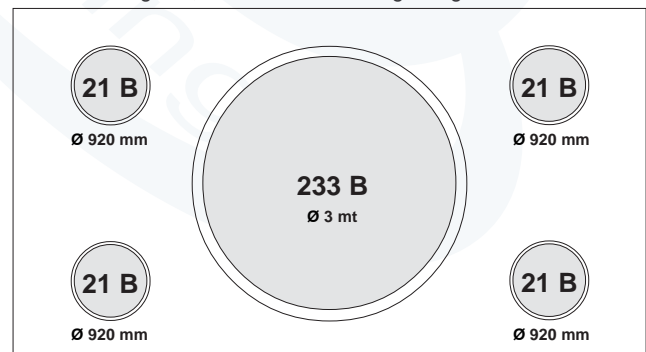

The propellant used has been heptane.  
Two fire tests have been performed, with extinction time of respectively 9 and 10 seconds; the test result was positive.

Classification obtained: - **EN 1866 - 233 IV B** - the highest.

**Technical specifications**

Cylinder "Ø" : 245 mm +0 -15 mm  
Material : AISI 304  
Operating pressure : 13 bar a 20°C  
Test pressure according 97/23/EC : 30 bar  
Burst pressure : >55 bar  
Temperature range : +0°C +60°C  
Extinguishing agent A.F.F.F. : 2% Sealfire®  
Propellant : nitrogen or dry air

Nominal charge : 25 lt  
Discharge time ~ : 34 sec  
Jet length ~ : 8 m  
**Dimensions**  
Height ~ : 1020 mm  
Width ~ : 390 mm  
Depth ~ : 535 mm  
Weight ~ : 60 kg

**Complete replacement spare parts**

**31303\_11 Including:**  
Sealfire, O-ring 2" and 4", washer rings, filter+coupling, safety seal.

The SOLAS Convention Chapter II-2 part C lays the obligation of the provision of replacement spare change for the 100% for the first 10 extinguishers installed, while the remaining fire extinguishers are needed the 50% of the replacement spare. The maximum quantity of refills shown are 60.

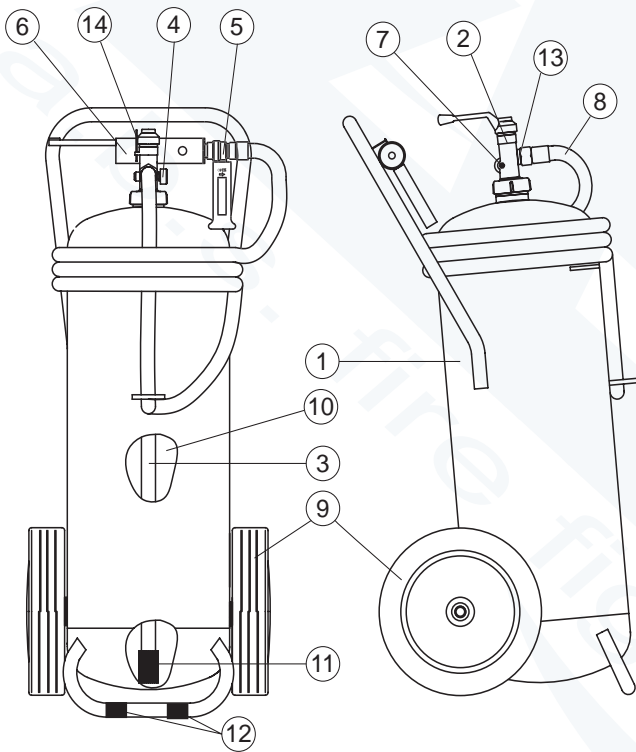

**Spare part list**

| Pos. | Description   | Code             | Q.ty   |
|------|---|------------------|--------|
| 1    | Cylinder (lt 33) <b>Stainless steel</b>                 | 27034_1          | 1      |
| 2    | Lever valve brass                                       | 21820_1          | 1      |
| 3    | Siphon tube PVC   | 21745            | 1      |
| 4    | Manometer M10x1 Ø 27 mm brass                           | 21534            | 1      |
| 5    | Turning valve brass 3/4"                                | 66030            | 1      |
| 6    | Foam nozzle light alloy                                 | 21006            | 1      |
| 7    | Safety device (in 3 pieces)                             | 21083            | 1      |
| 8    | Discharge hose L 5 mt<br><b>On request hose L 10 mt</b> | 20649<br>20649_1 | 1      |
| 9    | Ø 300 mm wheels rubber and plastic                      | 21931            | 2      |
| 10   | Sealfire 0.5L   | 21093            | 0.5 lt |
| 11   | 3/4" Filter + coupling                                  | 83011 + 20024    | 1      |
| 12   | Cap for protection foot cylinder                        | 28072            | 2      |
| 13   | Washer ring teflon 3/4" - 13x24x2                       | 20049            | 1      |
| 14   | Safety pin  | 21089            | 1      |

Available antifreeze -20°C or -30°C

**Detachable frame**  
No welding on the cylinder ensure better and higher safety.



**Welded frame.**  
The axe and carrying handle are welded on the cylinder body.



The family 14225 include more than one type of version.  
14225\_1 - Detachable frame - **Stainless steel cylinder.**  
14225\_2 - Welded frame - Cylinder painted inside.  
14225\_3 - Detachable frame - Cylinder painted inside.  
**In accordance** with the Directive 96/98/EC by the SOLAS 74 convention, resolutions and circulars of the IMO, EN 1866-1:2007 on the Annex A.1/3.52 Directive 2008/67/CE of the certificate and Notified by CSI SpA - No 0497.

The use of non original spare parts may cause malfunctions loss

**Maintenance and Guarantee**

Maintenance must be made periodically by, trained and certified staff, according to the local regulations of the country where it is located. The extinguisher is guaranteed for 12 months from the date of the supply. The guarantee includes, repairing or replacement, as manufacturer option. Unit must be sent back to the factory free of charge, only when authorized written agreement with our sales office has been reached. The guarantee expires in case of tampering and bad maintenance made by not-authorized staff, or transport damages. It must be recharged only by staff authorized and certified by **a.b.s. S.r.l.**, use only genuine original spare parts.

# 14226 Foam Wheeled It 50 Stainless steel

Approved EN 1866-1:2008, Marina MED, highest rate achieved - A IVB



CSi Certificate  
MED/0497/138/09



Organic solid materials,  
wood rubber, textiles etc.



Flammable liquids,  
gasoline, oil etc.

### According directive 96/98/EC, EN 1866 and with CE-mark

The wheeled fire extinguisher is manufactured according to Directive 96/98/EC (MED) with modules B and D. As with portable extinguishers, wheeled units also have to comply with high standards to ensure their extinguishing capability (fire rating), quality and reliability.

We at a.b.s. know how important it is to make the right choice in fire fighting.

Recently, a new European standard for wheeled extinguishers, EN 1866, was introduced.

The a.b.s. wheeled extinguisher range is one of the first in Europe to comply with this standard.

The wheeled units also carry the CE mark so the range can boast three quality guarantees :a.b.s. (ISO 9001), compliance with EN 1866 and the CE mark.

The standard EN1866 defines important minimum levels of pressure retention, corrosion protection, operating temperatures and fire rating.

### Technical Characteristics

Wheeled extinguisher is designed for professional use under severe circumstances, resulting in a high level of quality and ease of use.

The cylinder, CE marked, it has the welded frame or detachable frame.

Ease of mobility is achieved as a result of the large wheels with solid rubber tyres and push bar also ensuring good stability during operation.

### 2" Lever valve

The valve is made in brass (STCW617N) and it passed all the requirements of the directive 97/23/EC.

There is a safety device at 22 bar. There is a green safety seal to improve the optical check from far.

Only a simple glance is enough to check if the extinguisher has been tampered.

### Pressure gauge

Pressure gauge is brass galvanized the thread is M10x1 with o-ring for easy unscrew to check the real internal pressure any time without need of tools.

If the indicator is in the green field, the extinguisher is ready to be used. If the indicator is in the red field, call immediately the authorized service staff.

### Discharge device

Equipped with a highly flexible hose made in EPDM rubber with an excellent resistance manufactured from selected synthetic materials complete with a pistol.

The specially designed ergonomic patented foam nozzle ensures a steady flow of foam with a very low drop in pressure.

### Extinguishing agent

Sealfire® Super concentrate is the most powerful product registered by a.b.s. s.r.l. formulated for fire extinguisher.

It is an additive AFFF based, specially formulated for best sealing effects.

Permanent stored pressure



**Stainless Steel Cylinder**

**Swivel coupling**  
It allows easy unrolling of the hose avoiding twisting

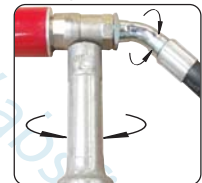

### Advantages

- Very mobile and easy to operate
- Excellent quality, therefore a long operational lifetime
- Good ergonomoy, easy to drive
- Extremely high ratings on A, B fires (solid combustibles, liquid fuels)
- Can be used at low temperatures (+0°C).  
On request -30°C or -20°C.
- Easy to service
- First in Europe in accordance with the new EN 1866 standards
- With CE approval
- Other Foam types available.

### - Test method and result -

The 233B tray has been used and four 21B trays have been installed alongside, as from the following design.

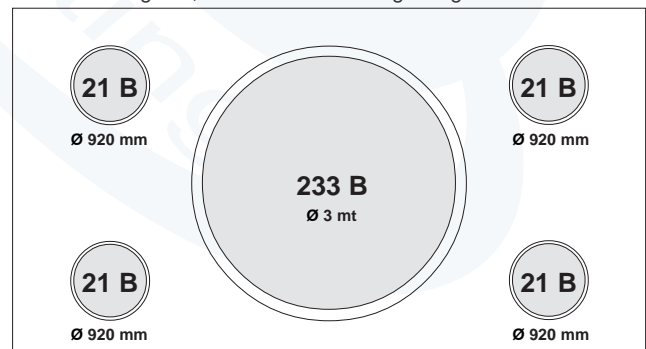

The propellant used has been heptane.

Two fire tests have been performed, with extinction time of respectively 9 and 10 seconds; the test result was positive.

Classification obtained: - **EN 1866 - 233 IV B** - the highest.

**Technical specifications**

Cylinder "Ø"..... : **315 +0 -15 mm**  
 Material..... : **AISI 304**  
 Operating pressure..... : **13 bar a 20°C**  
 Test pressure according 97/23/EC..... : **30 bar**  
 Burst pressure..... : **>55 bar**  
 Temperature range..... : **-30°C +60°C**  
 Extinguishing agent ..... : **2% Sealfire®-30**  
 Propellant..... : **nitrogen or dry air**

Nominal charge..... : **50 lt**  
 Discharge time ~..... : **45 sec**  
 Jet length ~..... : **8 m**  
**Dimensions**  
 Height ~..... : **1140 mm**  
 Width ~..... : **450 mm**  
 Depth ~..... : **550 mm**  
 Weight ~..... : **80 kg**

**Complete replacement spare parts**

**31303\_17 Including:**

Sealfire, O-ring 2" and 4", washer rings, filter+coupling, safety seal.

The SOLAS Convention Chapter II-2 part C **lays the obligation** of the provision of replacement spare change for the 100% for the first 10 extinguishers installed, while the remaining fire extinguishers are needed the 50% of the replacement spare. The maximum quantity of refills shown are 60.

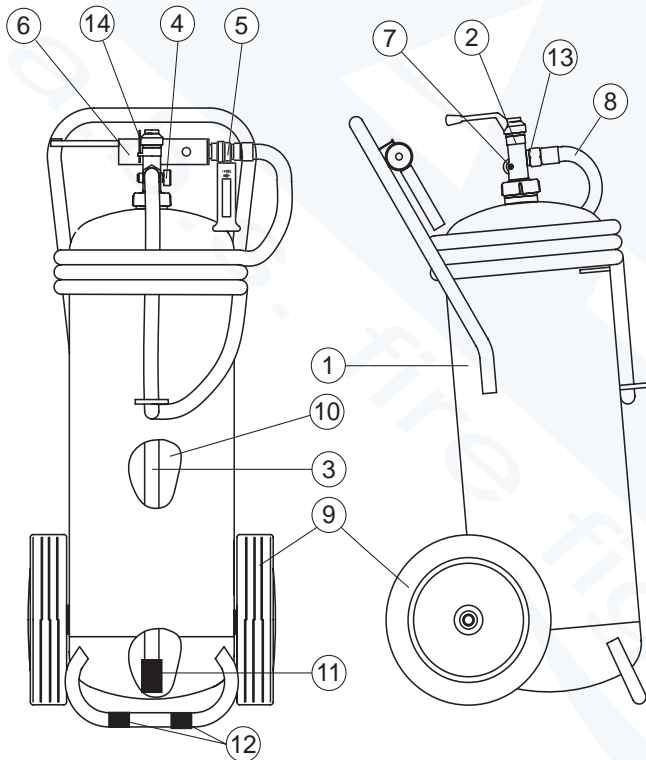

**Spare part list**

| Pos. | Description   | Code             | Q.ty         |
|------|---|------------------|--------------|
| 1    | Cylinder (lt 64) <b>Stainless steel</b>                 | 27820_1          | 1            |
| 2    | Lever valve brass                                       | 21820_1          | 1            |
| 3    | Siphon tube PVC   | 21737            | 1            |
| 4    | Manometer M10x1 Ø 27 mm brass                           | 21522            | 1            |
| 5    | Turning valve brass 3/4"                                | 66030            | 1            |
| 6    | Foam nozzle light alloy                                 | 21006            | 1            |
| 7    | Safety device (in 3 pieces)                             | 21083            | 1            |
| 8    | Discharge hose L 5 mt<br><b>On request hose L 10 mt</b> | 20649<br>20649_1 | 1            |
| 9    | Ø 300 mm wheels rubber and plastic                      | 21931            | 2            |
| 10   | Sealfire 1L<br>Antifreeze                               | 21093<br>33108   | 1 lt<br>25lt |
| 11   | 3/4" Filter + coupling                                  | 83011 + 20024    | 1            |
| 12   | Cap for protection foot cylinder                        | 28072            | 2            |
| 13   | Washer ring teflon 3/4" - 13x24x2                       | 20049            | 1            |
| 14   | Safety pin  | 21089            | 1            |

**Available antifreeze -20°C or -30°C**

The family 14226 include more than one type of version.  
**14226\_1** - Detachable frame - **Stainless steel cylinder.**  
**14226\_2** - Welded frame - Cylinder painted inside.  
**14226\_3** - Detachable frame - Cylinder painted inside.  
**In accordance** with the Directive 96/98/EC by the SOLAS 74 convention, resolutions and circulars of the IMO, EN 1866-1:2007 on the Annex A.1/3.52 Directive 2008/67/CE of the certificate and Notified by CSI SpA - No 0497.

**Detachable frame**  
 No welding on the cylinder ensure better and higher safety.



**Welded frame.**  
 The axe and carrying handle are welded on the cylinder body.



The use of non original spare parts may cause malfunctions loss

**Maintenance and Guarantee**

Maintenance must be made periodically by, trained and certified staff, according to the local regulations of the country where it is located. The extinguisher is guaranteed for 12 months from the date of the supply. The guarantee includes, repairing or replacement, as manufacturer option. Unit must be sent back to the factory free of charge, only when authorized written agreement with our sales office has been reached. The guarantee expires in case of tampering and bad maintenance made by not-authorized staff, or transport damages. It must be recharged only by staff authorized and certified by **a.b.s. S.r.l.**, use only genuine original spare parts.

# 14254 Foam Wheeled It 50 Stainless steel

Approved EN 1866-1:2008, Marina MED, highest rate achieved - A IVB



CSi Certificate  
 MED/0497/137/09



Organic solid materials,  
 wood rubber, textiles etc.



Flammable liquids,  
 gasoline, oil etc.

### According directive 96/98/EC, EN 1866 and with CE-mark

The wheeled fire extinguisher is manufactured according to Directive 96/98/EC (MED) with modules B and D. As with portable extinguishers, wheeled units also have to comply with high standards to ensure their extinguishing capability (fire rating), quality and reliability.

We at a.b.s. know how important it is to make the right choice in fire fighting.

Recently, a new European standard for wheeled extinguishers, EN 1866, was introduced.

The a.b.s. wheeled extinguisher range is one of the first in Europe to comply with this standard.

The wheeled units also carry the CE mark so the range can boast three quality guarantees :a.b.s. (ISO 9001), compliance with EN 1866 and the CE mark.

The standard EN1866 defines important minimum levels of pressure retention, corrosion protection, operating temperatures and fire rating.

### Technical Characteristics

Wheeled extinguisher is designed for professional use under severe circumstances, resulting in a high level of quality and ease of use.

The cylinder, CE marked, it has the welded frame or detachable frame.

Ease of mobility is achieved as a result of the large wheels with solid rubber tyres and push bar also ensuring good stability during operation.

### 2" Lever valve

The valve is made in brass (STCW617N) and it passed all the requirements of the directive 97/23/EC.

There is a safety device at 22 bar. There is a green safety seal to improve the optical check from far.

Only a simple glance is enough to check if the extinguisher has been tampered.

### Pressure gauge

Pressure gauge is brass galvanized the thread is M10x1 with o-ring for easy unscrew to check the real internal pressure any time without need of tools.

If the indicator is in the green field, the extinguisher is ready to be used. If the indicator is in the red field, call immediately the authorized service staff.

### Discharge device

Equipped with a highly flexible hose made in EPDM rubber with an excellent resistance manufactured from selected synthetic materials complete with a pistol.

The specially designed ergonomic patented foam nozzle ensures a steady flow of foam with a very low drop in pressure.

### Extinguishing agent

Sealfire® Super concentrate is the most powerful product registered by a.b.s. s.r.l. formulated for fire extinguisher. It is an additive AFFF based, specially formulated for best sealing effects.

Permanent stored pressure



Stainless Steel Cylinder

Swivel coupling  
 It allows easy unrolling of the hose avoiding twisting

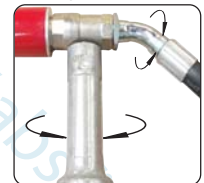

### Advantages

- Very mobile and easy to operate
- Excellent quality, therefore a long operational lifetime
- Good ergonomics, easy to drive
- Extremely high ratings on A, B fires (solid combustibles, liquid fuels)
- Can be used at low temperatures (+0°C). On request -30°C or -20°C.
- Easy to service
- First in Europe in accordance with the new EN 1866 standards
- With CE approval
- Other Foam types available.

### - Test method and result -

The 233B tray has been used and four 21B trays have been installed alongside, as from the following design.

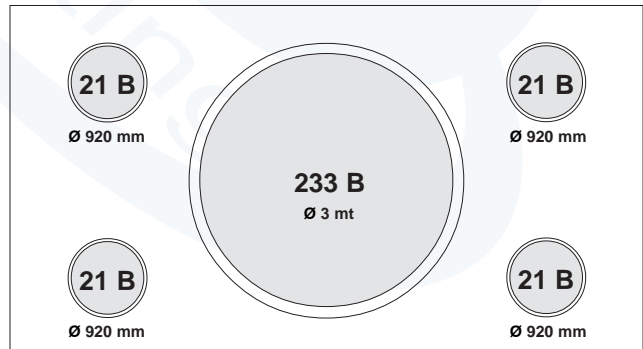

The propellant used has been heptane.

Two fire tests have been performed, with extinction time of respectively 9 and 10 seconds; the test result was positive.

Classification obtained: - **EN 1866 - 233 IV B** - the highest.

**Technical specifications**

Cylinder "Ø" : 315 +0 -15 mm  
Material : AISI 304  
Operating pressure : 13 bar a 20°C  
Test pressure according 97/23/EC : 30 bar  
Burst pressure : >55 bar  
Temperature range : +0°C +60°C  
Extinguishing agent A.F.F.F. : 2% Sealfire®  
Propellant : nitrogen or dry air

Nominal charge : 50 lt  
Discharge time ~ : 45 sec  
Jet length ~ : 8 m  
**Dimensions**  
Height ~ : 1140 mm  
Width ~ : 450 mm  
Depth ~ : 550 mm  
Weight ~ : 80 kg

**Complete replacement spare parts**

**31303 Including:**

Sealfire, O-ring 2" and 4", washer rings, filter+coupling, safety seal.

The SOLAS Convention Chapter II-2 part C lays the obligation of the provision of replacement spare change for the 100% for the first 10 extinguishers installed, while the remaining fire extinguishers are needed the 50% of the replacement spare. The maximum quantity of refills shown are 60.

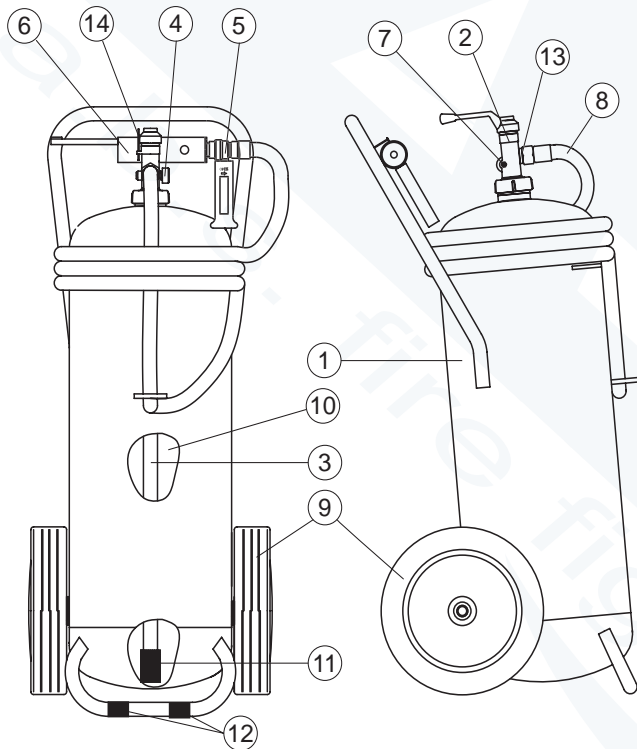

**Detachable frame**  
No welding on the cylinder ensure better and higher safety.



**Welded frame.**  
The axe and carrying handle are welded on the cylinder body.



The use of non original spare parts may cause malfunctions loss

**Spare part list**

| Pos. | Description   | Code             | Q.ty |
|------|---|------------------|------|
| 1    | Cylinder (lt 64) <b>Stainless steel</b>                 | 27820_1          | 1    |
| 2    | Lever valve brass                                       | 21820_1          | 1    |
| 3    | Siphon tube PVC   | 21706            | 1    |
| 4    | Manometer M10x1 Ø 27 mm brass                           | 21522            | 1    |
| 5    | Turning valve brass 3/4"                                | 66030            | 1    |
| 6    | Foam nozzle light alloy                                 | 21006            | 1    |
| 7    | Safety device (in 3 pieces)                             | 21083            | 1    |
| 8    | Discharge hose L 5 mt<br><b>On request hose L 10 mt</b> | 20649<br>20649_1 | 1    |
| 9    | Ø 300 mm wheels rubber and plastic                      | 21931            | 2    |
| 10   | Sealfire 1L   | 21093            | 1 lt |
| 11   | 3/4" Filter + coupling                                  | 83011 + 20024    | 1    |
| 12   | Cap for protection foot cylinder                        | 28072            | 2    |
| 13   | Washer ring teflon 3/4" - 13x24x2                       | 20049            | 1    |
| 14   | Safety pin  | 21089            | 1    |

**Available antifreeze -20°C or -30°C**

The family 14254 include more than one type of version.  
14254\_1 - Detachable frame - Stainless steel cylinder.  
14254\_2 - Welded frame - Cylinder painted inside.  
14254\_3 - Detachable frame - Cylinder painted inside.  
In accordance with the Directive 96/98/EC by the SOLAS 74 convention, resolutions and circulars of the IMO, EN 1866-1:2007 on the Annex A.1/3.52 Directive 2008/67/CE of the certificate and Notified by CSI SpA - No 0497.

**Maintenance and Guarantee**

Maintenance must be made periodically by, trained and certified staff, according to the local regulations of the country where it is located. The extinguisher is guaranteed for 12 months from the date of the supply. The guarantee includes, repairing or replacement, as manufacturer option. Unit must be sent back to the factory free of charge, only when authorized written agreement with our sales office has been reached. The guarantee expires in case of tampering and bad maintenance made by not-authorized staff, or transport damages. It must be recharged only by staff authorized and certified by a.b.s. S.r.l., use only genuine original spare parts.

# 14281 Foam Wheeled It 100 Stainless steel

Approved EN 1866-1:2008, Marina MED, highest rate achieved - A IVB



CSI Certificate  
MED/0497/141/09



Organic solid materials,  
wood rubber, textiles etc.



Flammable liquids,  
gasoline, oil etc.

### According directive 96/98/EC, EN 1866 and with CE-mark

The wheeled fire extinguisher is manufactured according to Directive 96/98/EC (MED) with modules B and D. As with portable extinguishers, wheeled units also have to comply with high standards to ensure their extinguishing capability (fire rating), quality and reliability.

We at a.b.s. know how important it is to make the right choice in fire fighting.

Recently, a new European standard for wheeled extinguishers, EN 1866, was introduced.

The a.b.s. wheeled extinguisher range is one of the first in Europe to comply with this standard.

The wheeled units also carry the CE mark so the range can boast three quality guarantees :a.b.s. (ISO 9001), compliance with EN 1866 and the CE mark.

The standard EN1866 defines important minimum levels of pressure retention, corrosion protection, operating temperatures and fire rating.

### Technical Characteristics

Wheeled extinguisher is designed for professional use under severe circumstances, resulting in a high level of quality and ease of use.

The cylinder, CE marked, it has the welded frame or detachable frame.

Ease of mobility is achieved as a result of the large wheels with solid rubber tyres and push bar also ensuring good stability during operation.

### 2" Lever valve

The valve is made in brass (STCW617N) and it passed all the requirements of the directive 97/23/EC.

There is a safety device at 22 bar. There is a green safety seal to improve the optical check from far.

Only a simple glance is enough to check if the extinguisher has been tampered.

### Pressure gauge

Pressure gauge is brass galvanized the thread is M10x1 with o-ring for easy unscrew to check the real internal pressure any time without need of tools.

If the indicator is in the green field, the extinguisher is ready to be used. If the indicator is in the red field, call immediately the authorized service staff.

### Discharge device

Equipped with a highly flexible hose made in EPDM rubber with an excellent resistance manufactured from selected synthetic materials complete with a pistol.

The specially designed ergonomic patented foam nozzle ensures a steady flow of foam with a very low drop in pressure.

### Extinguishing agent

Sealfire® Super concentrate is the most powerful product registered by a.b.s. s.r.l. formulated for fire extinguisher.

It is an advanced AFFF based, specially formulated for best sealing effects.

Permanent stored pressure



Stainless Steel Cylinder

Swivel coupling  
It allows easy unrolling of the hose avoiding twisting

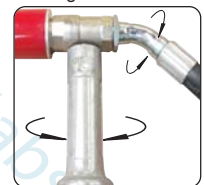

### Advantages

- Very mobile and easy to operate
- Excellent quality, therefore a long operational lifetime
- Good ergonomoy, easy to drive
- Extremely high ratings on A, B fires (solid combustibles, liquid fuels)
- Can be used at low temperatures (+0°C).  
On request -30°C or -20°C.
- Easy to service
- First in Europe in accordance with the new EN 1866 standards
- With CE approval
- Other Foam types available.

### - Test method and result -

The 233B tray has been used and four 21B trays have been installed alongside, as from the following design.

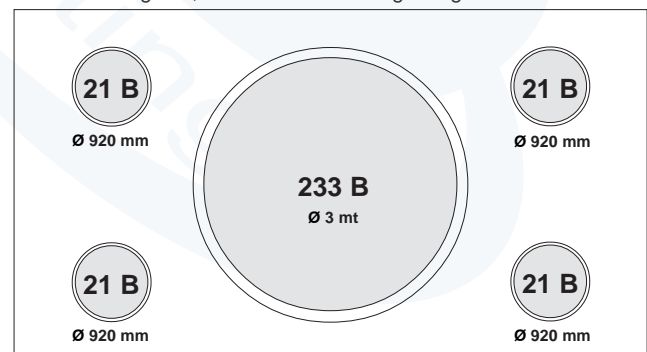

The propellant used has been heptane.

Two fire tests have been performed, with extinction time of respectively 9 and 10 seconds; the test result was positive.

Classification obtained: - **EN 1866 - 233 IV B** - the highest.

**Technical specifications**

|                                       |                       |                       |           |
|---------------------------------------|-----------------------|-----------------------|-----------|
| Cylinder "Ø".....                     | : 400 +0 -15 mm       | Nominal charge.....   | : 100 lt  |
| Material.....                         | : AISI 304            | Discharge time ~..... | : 99 sec  |
| Operating pressure.....               | : 13 bar a 20°C       | Jet length ~.....     | : 8 m     |
| Test pressure according 97/23/EC..... | : 30 bar              | <b>Dimensions</b>     |           |
| Burst pressure.....                   | : >55 bar             | Height ~.....         | : 1330 mm |
| Temperature range.....                | : +0°C +60°C          | Width ~.....          | : 550 mm  |
| Extinguishing agent A.F.F.F.....      | :2% Sealfire®         | Depth ~.....          | : 700 mm  |
| Propellant.....                       | : nitrogen or dry air | Weight ~.....         | : 160 kg  |

**Complete replacement spare parts**

**31303\_10 Including:**  
 Sealfire, O-ring 2" and 4", washer rings, filter+coupling, safety seal.

The SOLAS Convention Chapter II-2 part C **lays the obligation** of the provision of replacement spare change for the 100% for the first 10 extinguishers installed, while the remaining fire extinguishers are needed the 50% of the replacement spare. The maximum quantity of refills shown are 60.

**Spare part list**

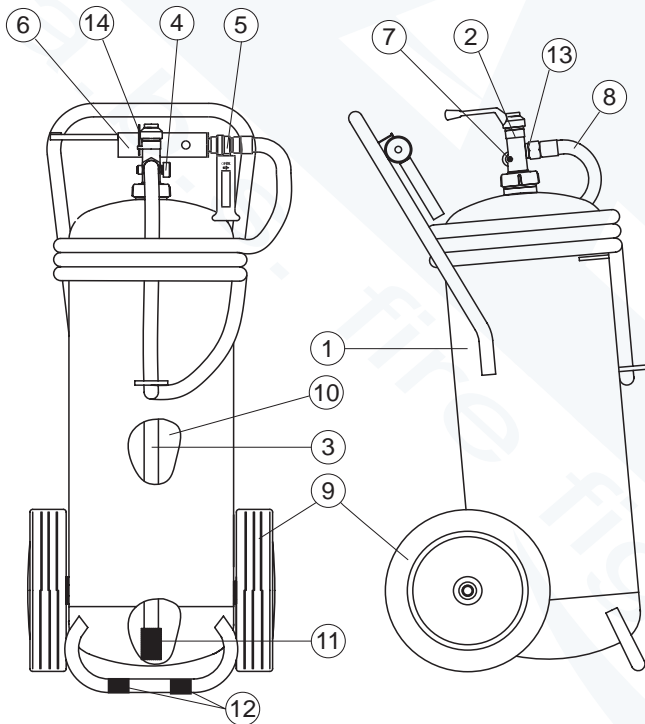

| Pos. | Description                              | Code          | Q.ty |
|------|--|---------------|------|
| 1    | Cylinder (lt 130) <b>Stainless steel</b> | 27019_1       | 1    |
| 2    | Lever valve brass                        | 21820_1       | 1    |
| 3    | Siphon tube PVC                          | 21730         | 1    |
| 4    | Manometer M10x1 Ø 27 mm brass            | 21522         | 1    |
| 5    | Turning valve brass 3/4"                 | 66030         | 1    |
| 6    | Foam nozzle light alloy                  | 21006         | 1    |
| 7    | Safety device (in 3 pieces)              | 21083         | 1    |
| 8    | Discharge hose L 5 mt                    | 20649         | 1    |
|      | <b>On request hose L 10 mt</b>           | 20649_1       |      |
| 9    | Ø 300 mm wheels rubber and plastic       | 21931         | 2    |
| 10   | Sealfire 2 lt                            | 21171         | 2 lt |
| 11   | 3/4" Filter + coupling                   | 83011 + 20024 | 1    |
| 12   | Cap for protection foot cylinder         | 28073         | 2    |
| 13   | Washer ring teflon 3/4" - 13x24x2        | 20049         | 1    |
| 14   | Safety pin                               | 21089         | 1    |

Available antifreeze -20°C or -30°C

**Detachable frame**  
 No welding on the cylinder ensure better and higher safety.

**Welded frame.**  
 The axe and carrying handle are welded on the cylinder body.



The family 14281 include more than one type of version.  
**14281\_1** - Detachable frame - **Stainless steel cylinder.**  
**14281\_2** - Welded frame - Cylinder painted inside.  
**14281\_3** - Detachable frame - Cylinder painted inside.  
**In accordance** with the Directive 96/98/EC by the SOLAS 74 convention, resolutions and circulars of the IMO, EN 1866-1:2007 on the Annex A.1/3.52 Directive 2008/67/CE of the certificate and Notified by CSI SpA - No 0497.

The use of non original spare parts may cause malfunctions loss

**Maintenance and Guarantee**

Maintenance must be made periodically by, trained and certified staff, according to the local regulations of the country where it is located. The extinguisher is guaranteed for 12 months from the date of the supply. The guarantee includes, repairing or replacement, as manufacturer option. Unit must be sent back to the factory free of charge, only when authorized written agreement with our sales office has been reached. The guarantee expires in case of tampering and bad maintenance made by not-authorized staff, or transport damages. It must be recharged only by staff authorized and certified by **a.b.s. S.r.l.**, use only genuine original spare parts.