

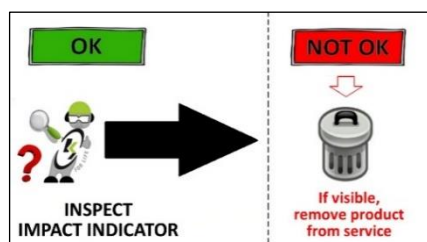







HOPÉ

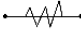

①



HS CODE
63079098
CARTON SIZE / PCS.
80 x 40 x 24 cm / 10
AET (EU) N°2777/10960-04/E01-01
Satra Technology Europe Ltd., N° 2777, Bracetown Business Park, Clonee, Dublin, D15YN2P, Ireland
MODULE D FI14/14003.01
SGS Fimko Oy, N°0598 Takomotie 8, 00380 HELSINKI, Finland
AET (UKCA) N°AB0321/16077-01/E02-01
Satra Technology Centre, N°0321 Wyndham Way, Telford Way, Kettering Northamptonshire, NN16 8SD, United Kingdom
MODULE D 11 IN14/14003
SGS United Kingdom Ltd., N°0120 Unit 202B, Worle Parkway, Weston-super-Mare, BS22 6WA, United Kingdom

REF.	FA 30 800 15
 LG. KG	1.25 m / 1.5 m (connectors included)
CE	EN 355:2002
MAT.	 45 mm  PES
	35 mm
	 SCREW / DOUBLE ACTION
	NO
+	PPE-R 11.063
	1.44 KG



Largeur de l'absorbeur d'énergie
 Width of the energy absorber
Ancho del absorbedor de energía
 Larghezza del assorbitore di energia
Breite des Falldämpfers

LG.



Longueur Poids maxi utilisateur
Length Max. user weight
Longitud Peso máximo del usuario
Lunghezza Peso Max. dell'utente
Länge Höchstgewicht des Benutzers



Matière connecteur haut / connecteur bas
 Material of top connector / bottom connector
Material conector alto / conector bajo
 Materiale connettore alto / connettore basso
Material oberes / unteres Verbindungselement



Homologué pour le travail à proximité d'arêtes vives
 Approved for work near sharp edges
Homologado para trabajo cerca de aristas vivas
 Omologato per lavoro in prossimità di spigoli vivi
Zugelassen für Arbeiten in der Nähe scharfer Kanten